

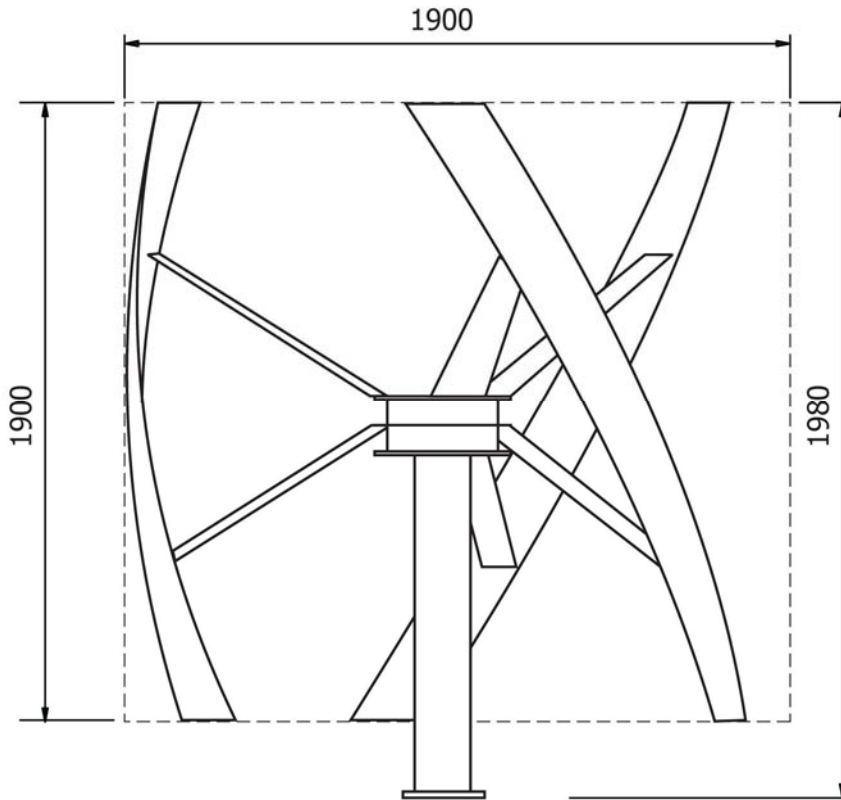

Helix Wind D361 Structural Design Summary



Rotor Dimensions: 1.9 m x 1.9 m (6.23 ft x 6.23 ft)

Overall Dimensions: 1.9 m x 1.98 m (6.23 ft x 6.49 ft)

Swept Area: 3.61 m²

Weight: 156 kg (344 lb)

Base Loads: @ 50 m/s (112 mph). Turbine in full brake mode.

Projected Area 1.54 m²

Vertical 1.6 kN

Shear 2.41 kN

Bending Moment 2.41 kN.m (1.78 kip.ft)

Torque 0.60 kN.m (0.442 kip.ft)

1848 Commercial St. San Diego Ca 92113

1-877-2gohelix

www.helixwind.com

© Helix Wind 2009. REV01



Mounting Plate:

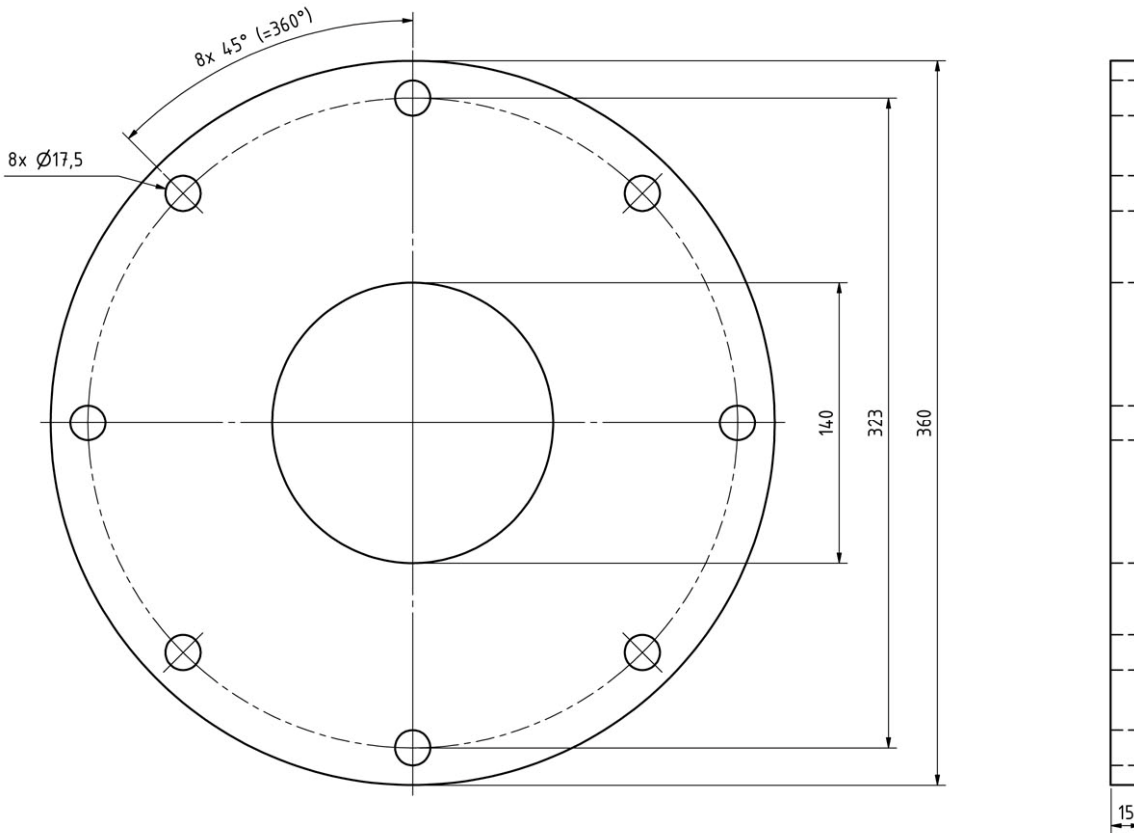

Bolts: M16-2.0 x 60mm Gr. 8.8 (Alt. 5/8-11 x 2.5" Gr. 8), zinc plate.
Use flat and lock washers.

Note: Reactions listed are NOT factored. An appropriate Safety Factor must be included in all structural design for mounting.