

REV. NO.		DESCRIPTION	DATE	APPROVED
1		INITIAL RELEASE	5/20/08	
2		ADDED NOTES AND MATERIAL SPECS	7/8/08	

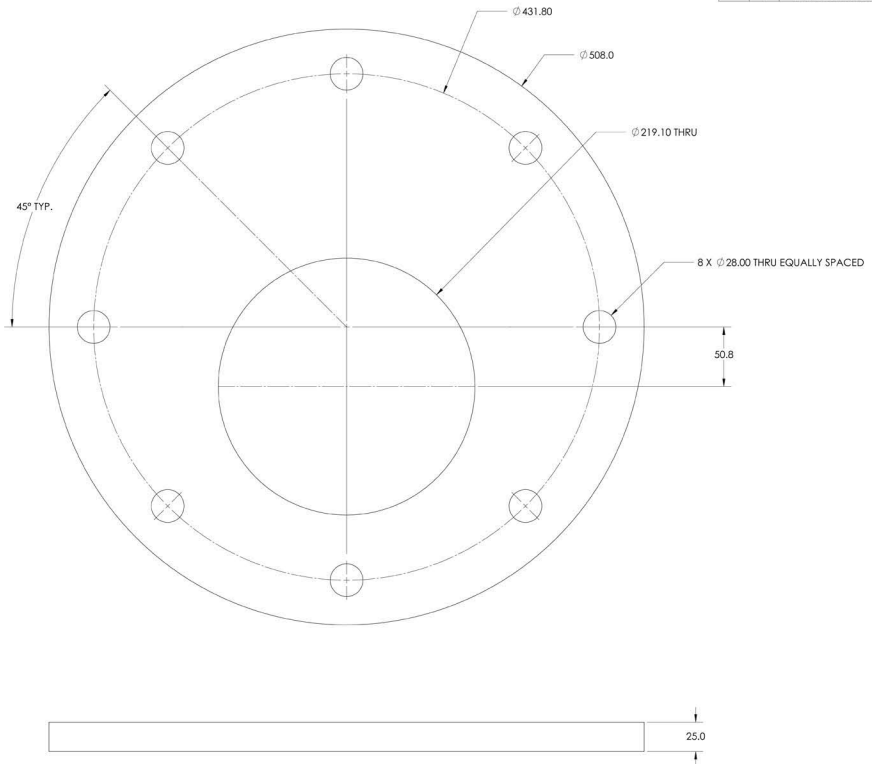

RELEASED OR REVISED: CHECKED DRAWN: DEKAWAY DATE: 3/17/08		TITLE: HELIX WIND 1848 COMMERCIAL ST. SAN DIEGO, CA 92113	
ALL DIMENSIONS IN MM UNLESS OTHERWISE SPECIFIED		TITLE: S594 BASE PLATE BOLT PATTERN	
SEE NOTES ALL DIMENSIONS IN MM		SIZE: DWG. NO. 302-10003 REV 2	
APPLICATION:		SCALE: 1:2 WEIGHT:	